



ARGCO's line of Cast Iron Threaded Fittings conform to, comply with the following standards:
ASTM A128 Class B Standard Spec for Cupola Cast Iron
ANSI B 16.4 Cast Iron Threaded Fittings Classes 125
ANSI/ASME B1.20.1 Pipe Threads, General Purpose (inch) NPT

CAST IRON THREADED FITTINGS CATALOG

ARGCO SALES: toll free: 800-854-1015

argco.com

international: 760-727-1644 | fax: 800-924-5922

email: info@argco.com



ARGCO offers a full line of Threaded Fittings. This line includes Malleable, Cast, Ductile and Brass Fittings, as well as Nipples and Welded Outlets.

Mix and match to receive volume discounts.

For pricing and shipping details, contact ARGCO's Sales Department at 800-854-1015.

Specifications

Cast Iron Threaded Fittings

ALL CAST IRONS MANUFACTURED FOR AND BY SIGMA PIPING PRODUCTS CONFORM TO, COMPLY WITH, AND ARE MANUFACTURED TO THE FOLLOWING STANDARDS:

ASTM A 128-

ANSI B 16.4-

ANSI/ASME B1.20.1-

Class B Standard Spec for Cupola Cast Iron

Cast Iron Threaded Fitting Classes 125

Pipe Threads, General Purpose (Inch) NPT

CAST IRON THREADED FITTINGS



■ C.I. Threaded fittings are UL, cUL listed and Factory Mutual approved for 300psi service. Gray iron per ASTM 126 class B. Dimensions conform to ANSI B 16.4 Class 125 except plugs conform to ASME B 16.14. Threads are NPT per ANSI/ASME B1.20.1.

Description
C.I. 90 Degree Elbow

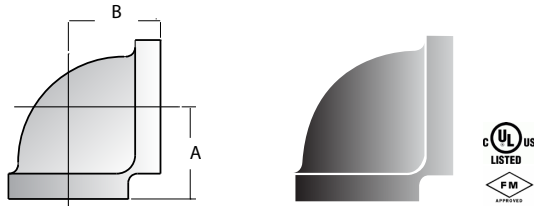

NOM SIZE	ITEM CODE	DIMENSION		ITEM WEIGHT
	BLACK	A	B	
1"	1C90B0606	1.50	1.50	0.85
1 1/4"	1C90B0707	1.75	1.75	1.22
1 1/2"	1C90B0808	1.94	1.94	1.55
2"	1C90B0909	2.25	2.25	2.45
2 1/2"	1C90B1010	2.70	2.70	4.80

Description
C.I. Reducing 90 Degree Elbow

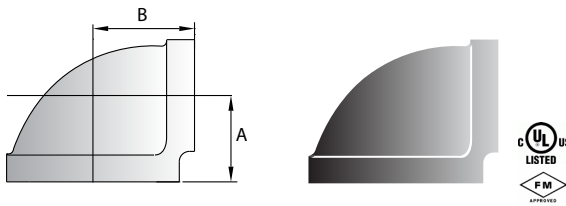

NOM SIZE	ITEM CODE	DIMENSION		ITEM WEIGHT
	BLACK	A	B	
1 X 1/2"	1C90R0604	1.26	1.36	0.44
1 X 3/4"	1C90R0605	1.37	1.45	0.52
1 1/4 X 1/2"	1C90R0704	1.34	1.53	0.64
1 1/4 X 3/4"	1C90R0705	1.45	1.62	0.72
1 1/4" X 1"	1C90R0706	1.58	1.67	0.75
1 1/2" X 1/2"	1C90R0804	1.60	1.70	1.17
1 1/2" X 3/4"	1C90R0805	1.61	1.72	1.30
1 1/2" X 1"	1C90R0806	1.65	1.80	0.92
1 1/2" X 1 1/4"	1C90R0807	1.82	1.88	1.08
2" X 1/2"	1C90R0904	1.49	1.88	1.08
2" X 3/4"	1C90R0905	1.60	1.97	1.24
2" X 1"	1C90R0906	1.73	2.02	1.40
2" X 1 1/4"	1C90R0907	1.90	2.10	1.52
2" X 1 1/2"	1C90R0908	2.02	2.16	1.65

Description
C.I. Straight Tee



NOM SIZE	ITEM CODE	DIMENSION		ITEM WEIGHT
	BLACK	A	B	
1"	1CT060606	1.50	1.50	0.85
1 1/4"	1CT070707	1.75	1.75	1.22
1 1/2"	1CT080808	1.94	1.94	1.55
2"	1CT090909	2.25	2.25	2.45
2 1/2"	1CT101010	2.70	2.70	6.39

Description
C.I. 45 Degree Elbow

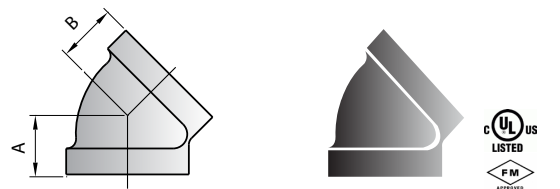

NOM SIZE	ITEM CODE	DIMENSION		ITEM WEIGHT
	BLACK	A	B	
1"	1C45B0606	1.12	1.12	0.46
1 1/4"	1C45B0707	1.29	1.29	0.73
1 1/2"	1C45B0808	1.43	1.43	0.92
2"	1C45B0909	1.68	1.68	1.50

Description
C.I. Reducing Coupling



NOM SIZE	ITEM CODE	DIM. A	ITEM WEIGHT
	BLACK	A	
1 X 1/2"	1CCR0604	1.69	0.62
1 X 3/4"	1CCR0605	1.69	0.69

CAST IRON THREADED FITTINGS



Description C.I. Reducing Tee

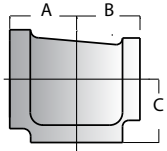

NOM SIZE	ITEM CODE BLACK	DIMENSION			ITEM WEIGHT
		A	B	C	
1" x 1" x 1/2"	1CT060604	1.26	1.26	1.36	0.95
1" x 1" x 3/4"	1CT060605	1.37	1.37	1.45	1.10
1" x 1/2" x 1"	1CT060406	1.50	1.36	1.50	1.08
1" x 3/4" x 1"	1CT060506	1.50	1.45	1.50	1.18
1" x 1" x 1 1/4"	1CT060607	1.67	1.67	1.58	1.52
1" x 1" x 1 1/2"	1CT060608	1.80	1.80	1.65	1.73
1 1/4" x 1" x 1/2"	1CT070604	1.34	1.26	1.53	1.17
1 1/4" x 1" x 3/4"	1CT070605	1.45	1.37	1.62	1.38
1 1/4" x 1" x 1"	1CT070606	1.58	1.50	1.57	1.47
1 1/4" x 1" x 1 1/4"	1CT070607	1.75	1.67	1.75	1.80
1 1/4" x 1" x 1 1/2"	1CT070608	1.88	1.80	1.82	2.05
1 1/4" x 1 1/4" x 1/2"	1CT070704	1.34	1.34	1.53	1.37
1 1/4" x 1 1/4" x 3/4"	1CT070705	1.45	1.45	1.62	1.54
1 1/4" x 1 1/4" x 1"	1CT070706	1.58	1.58	1.67	1.65
1 1/4" x 1 1/4" x 1 1/2"	1CT070708	1.88	1.88	1.82	2.21
1 1/4" x 1 1/4" x 2"	1CT070709	2.10	2.10	1.90	2.55
1 1/2" x 1" x 1/2"	1CT080604	1.41	1.34	1.66	1.41
1 1/2" x 1" x 3/4"	1CT080605	1.52	1.37	1.75	1.65
1 1/2" x 1" x 1"	1CT080606	1.65	1.50	1.80	1.65
1 1/2" x 1" x 1 1/4"	1CT080607	1.82	1.67	1.88	2.00
1 1/2" x 1" x 1 1/2"	1CT080608	1.94	1.80	1.94	2.30
1 1/2" x 1 1/4" x 1/2"	1CT080704	1.41	1.34	1.66	1.58
1 1/2" x 1 1/4" x 3/4"	1CT080705	1.52	1.45	1.75	1.72
1 1/2" x 1 1/4" x 1"	1CT080706	1.65	1.58	1.80	1.85
1 1/2" x 1 1/4" x 1 1/4"	1CT080707	1.82	1.75	1.88	2.22
1 1/2" x 1 1/4" x 1 1/2"	1CT080708	1.94	1.88	1.94	2.45
1 1/2" x 1 1/4" x 2"	1CT080709	2.16	2.10	2.02	2.80
1 1/2" x 1 1/2" x 1/2"	1CT080804	1.41	1.41	1.66	1.76
1 1/2" x 1 1/2" x 3/4"	1CT080805	1.52	1.52	1.75	1.87
1 1/2" x 1 1/2" x 1"	1CT080806	1.65	1.65	1.80	1.94
1 1/2" x 1 1/2" x 1 1/4"	1CT080807	1.82	1.82	1.88	2.29
1 1/2" x 1 1/2" x 2"	1CT080809	2.16	2.16	2.02	3.28
2" x 1" x 2"	1CT090609	2.25	2.02	2.25	3.40
2" x 1 1/4" x 2"	1CT090709	2.25	2.10	2.25	2.80
2" x 1 1/2" x 1/2"	1CT090804	1.49	1.41	1.88	2.09
2" x 1 1/2" x 3/4"	1CT090805	1.60	1.52	1.97	2.40
2" x 1 1/2" x 1"	1CT090806	1.73	1.65	2.02	2.54
2" x 1 1/2" x 1 1/4"	1CT090807	1.90	1.82	2.10	2.85
2" x 1 1/2" x 1 1/2"	1CT090808	1.49	1.41	1.88	2.24
2" x 1 1/2" x 2"	1CT090809	2.25	2.16	2.25	3.75
2" x 2" x 1/2"	1CT090904	1.49	1.49	1.88	2.60
2" x 2" x 3/4"	1CT090905	1.60	1.60	1.97	2.71
2" x 2" x 1"	1CT090906	1.73	1.73	2.02	2.97
2" x 2" x 1 1/4"	1CT090907	1.90	1.90	2.10	3.32
2" x 2" x 1 1/2"	1CT090908	2.02	2.02	2.16	3.72
2" x 2" x 2 1/2"	1CT090910	2.60	2.60	2.39	5.10

Description C.I. Plugs

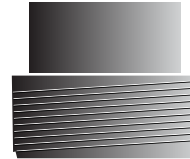
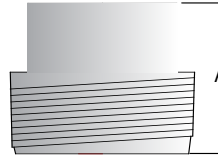

NOM SIZE	ITEM CODE BLACK	DIM. A	ITEM WEIGHT
3/4"	1CPLG0505	1.07	0.17
1"	1CPLG0606	1.25	0.28
1 1/4"	1CPLG0707	1.36	0.44
1 1/2"	1CPLG0808	1.45	0.62
2"	1CPLG0909	1.56	0.91

Description C.I. Cross

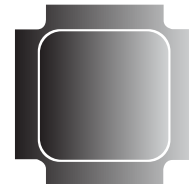
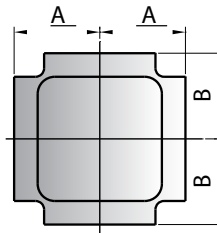

NOM SIZE	ITEM CODE BLACK	DIMENSION		ITEM WEIGHT
		A	B	
1"	1CX0606	1.50	1.50	1.54
1 1/4"	1CX0707	1.75	1.75	2.40
1 1/2"	1CX0808	1.94	1.94	3.10
2"	1CX0909	2.25	2.25	4.00
1 1/4" X 1"	1CX0706	1.58	1.67	2.05
1 1/2" X 1"	1CX0806	1.65	1.80	2.40
2" X 1"	1CX0906	1.73	2.02	2.75

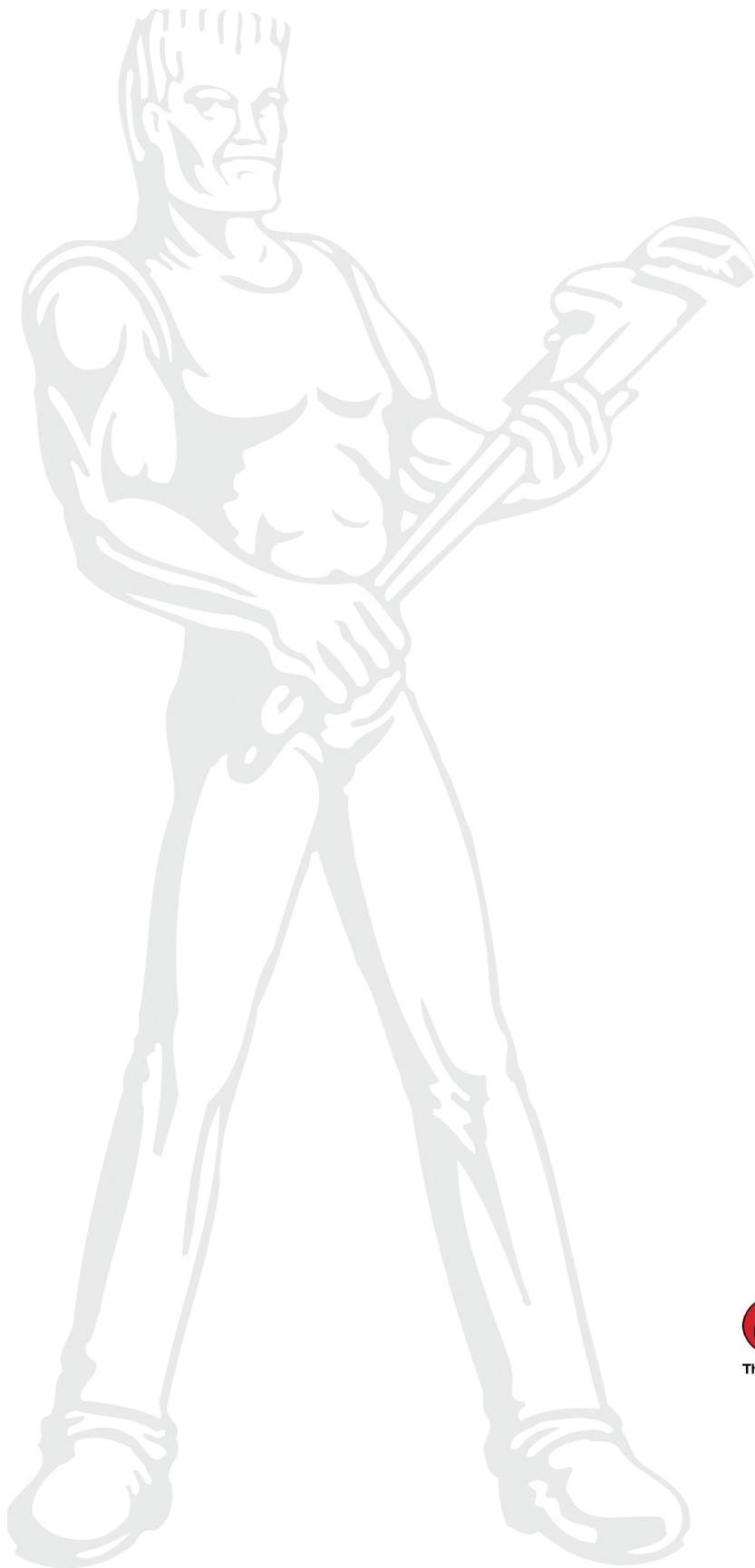

ARGCO.com

For more products, pricing, technical data, SDS, log onto: www.argco.com

ARGCO SALES: toll free: 800-854-1015
international: 760-727-1644 | fax: 800-924-5922
email: info@argco.com